

DWFK-31785-B75

SHT 1.1

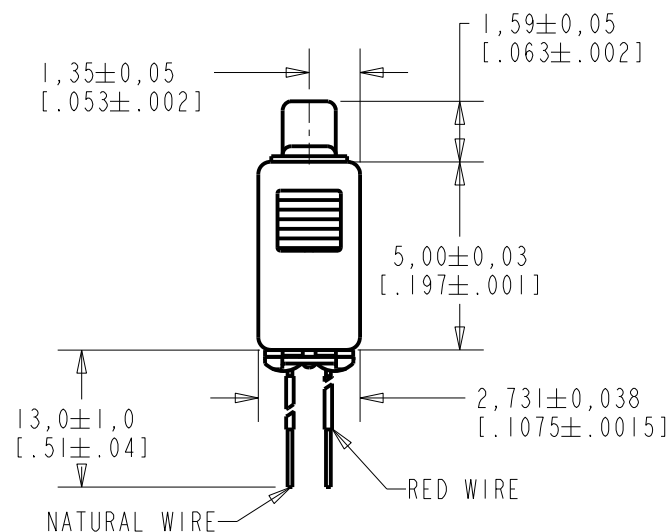

NOTES:

- 1 A POSITIVE GOING VOLTAGE AT TERMINAL 2, RELATIVE TO TERMINAL 1, CAUSES A DECREASE IN PRESSURE AT THE SOUND OUTLET.
- 2 LOCATED FROM TWO SURFACES FOR CUSTOMER CONVENIENCE. ONLY APPLICABLE FROM ONE SURFACE, NOT TO BE USED TOGETHER.

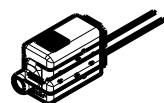
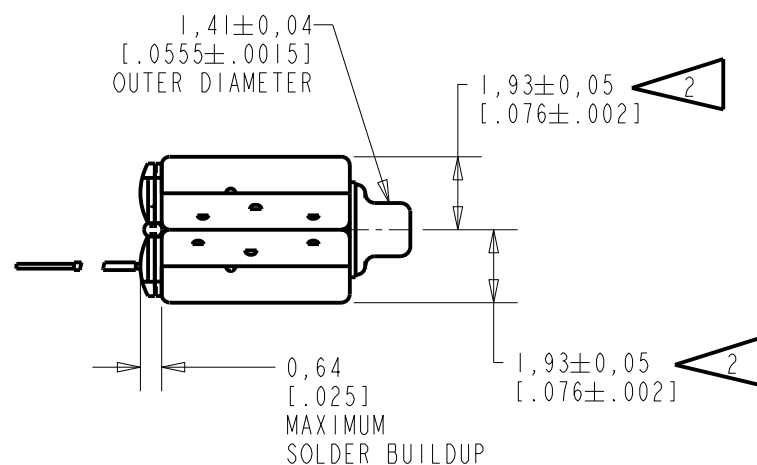
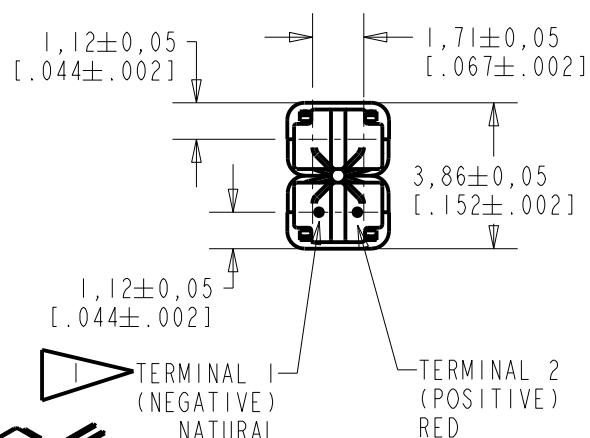

SCALE 2:1

DIMENSIONS IN MILLIMETERS [INCHES]

KNOWLES ELECTRONICS
ITASCA, ILLINOIS U.S.A.

Revision	C.O. #	Implementation Date	RELEASE LEVEL	REVISION
			Active	A
A	C40101323	10-25-13		
SCALE: 5:1			DR. BY	DATE
DO NOT SCALE DRAWING			LW	10-25-13
TITLE: RECEIVER ASSEMBLY DWFK-31785-B75			CK. BY	DATE
OUTLINE DRAWING			GJP	11-1-13
SHT 1.1			APP. BY	DATE
			GJP	11-1-13

KE111ASIZE.FRM

Rev: B

A PAIR OF MAGNETIC BALANCED ARMATURE RECEIVERS WITH LEADS ATTACHED WITH EXTENDED HIGH FREQUENCY RESPONSE INTENDED FOR USE IN A HI-FI SYSTEM.

NO DAMPING

DWFK-31785-B75
SHEET 2.1

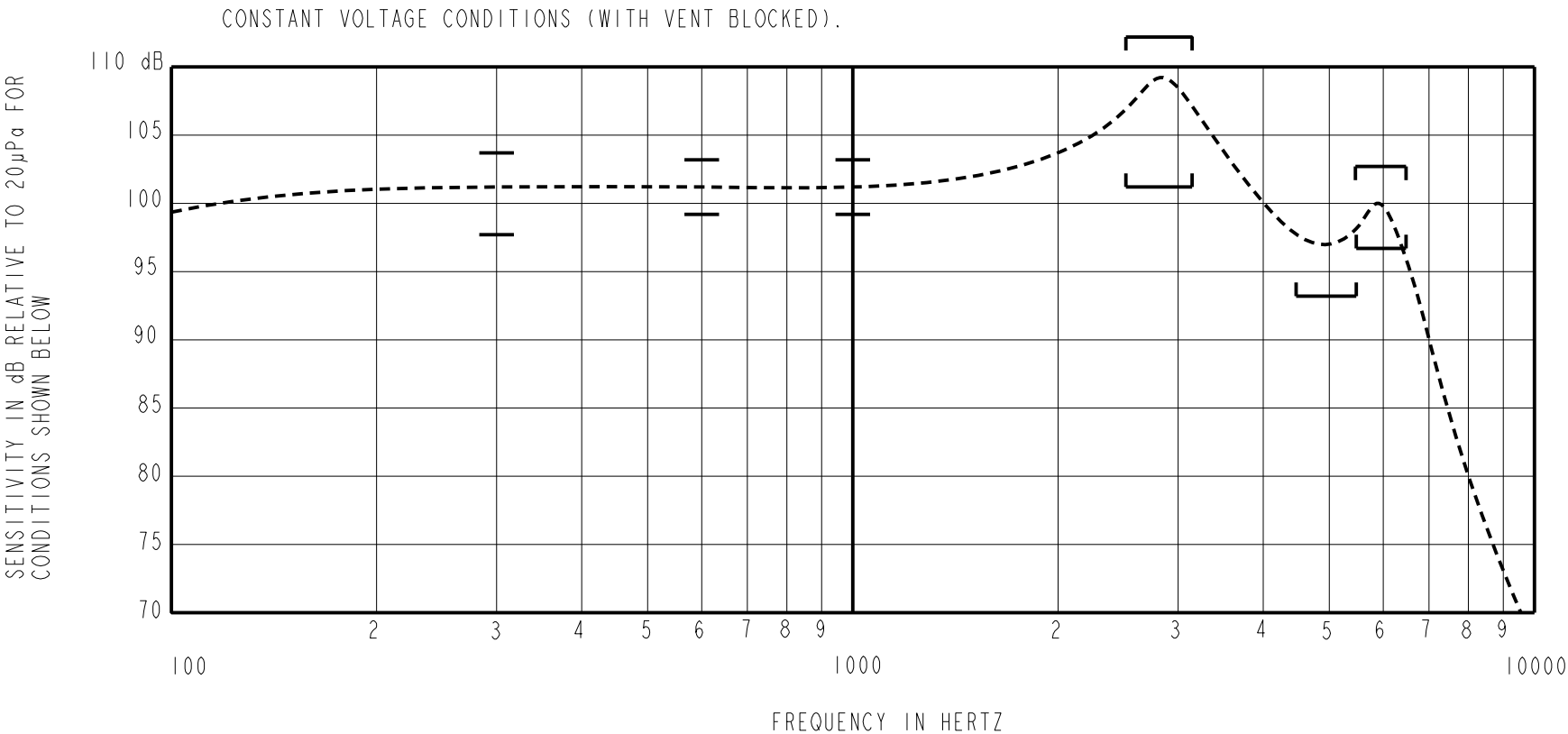

ACOUSTICAL

SENSITIVITY
DEVICE WILL PRODUCE THE SPL LISTED BELOW UNDER TEST CONDITIONS IN TABLE 3.
NOMINAL SENSITIVITY AT 1kHz IS dB RELATIVE TO 20 μ Pa. ALL OTHER VALUES
IN dB RELATIVE TO THE SENSITIVITY AT 1kHz.

LIMIT TYPE	FREQUENCY (Hz)	MINIMUM	NOMINAL	MAXIMUM
REL	200	-3.5	-0.5	+2.5
REL	500	-2.0	0.0	+2.0
REF	1000	-2.0	101.2	+2.0
PEAK1	2565-3165	+5.0	+8.0	+11.0
VALLEY1	4500-5500	-8.0	---	---
PEAK2	5500-6500	-4.5	-1.5	+1.5

TABLE 1

TOTAL HARMONIC DISTORTION
DEVICE WILL NOT EXCEED TOTAL HARMONIC DISTORTION LEVELS LISTED BELOW.

FREQUENCY (Hz)	AC DRIVE (Vrms)	DC BIAS (V)	LIMIT (%)
1/3 PEAK1 (TYP.955)	0.146	0	5
1/2 PEAK1 (TYP.1433)	0.146	0	5
1/3 PEAK1 (TYP.955)	0.411	0	10
1/2 PEAK1 (TYP.1433)	0.411	0	10

TABLE 2

TEST CONDITIONS

NOMINAL SOURCE VOLTAGE	0.146 Vrms, 0 mA DC BIAS
SOURCE IMPEDANCE	<0.2 Ohm
TUBING	10mm [.394"] LONG, 1mm [.039"] I.D.
COUPLER CAVITY	2 cm ³ , SIMULATED ANSI S3.7 TYPE HA-3 (IEC 60318-5)

TABLE 3

ELECTRICAL

DC RESISTANCE	25.0 Ohms \pm 10%*
IMPEDANCE @ 500 Hz	26.8 Ohms \pm 15%*
IMPEDANCE @ 1kHz	30.1 Ohms \pm 15%*

TABLE 4

ISOLATION: CASE WILL BE ELECTRICALLY ISOLATED FROM THE COIL CIRCUIT.

MECHANICAL

PORT LOCATION: 12S
SOLDER TYPE: SAC305
TEMPERATURE
OPERATING: SENSITIVITY WILL NOT VARY MORE
THAN +1 / -3 dB FROM -17°C TO 63°C.
STORAGE: -40°C TO 63°C.

Revision	C.O. #	Implementation Date	RELEASE LEVEL	REVISION
			Active	A
A	C40101323	10-25-13		
WHEN TEST LIMITS ARE USED TO ESTABLISH INCOMING INSPECTION ACCEPTANCE/REJECTION CRITERIA, CORRELATION OF TEST EQUIPMENT WITH KNOWLES IS ALSO REQUIRED FOR ELIMINATION OF EQUIPMENT AND TEST METHOD VARIATION			DR. BY LW	DATE 10-25-13
TITLE: RECEIVER ASSEMBLY			CK. BY GJP	DATE 11-1-13
PERFORMANCE SPECIFICATION			APP. BY GJP	DATE 11-1-13
DWFK-31785-B75			SHT 2.1	

KNOWLES ELECTRONICS
ITASCA, ILLINOIS U.S.A.